

SOLAR - CODE ANALYSIS - STREET LEVEL 1/8" = 1'-0"

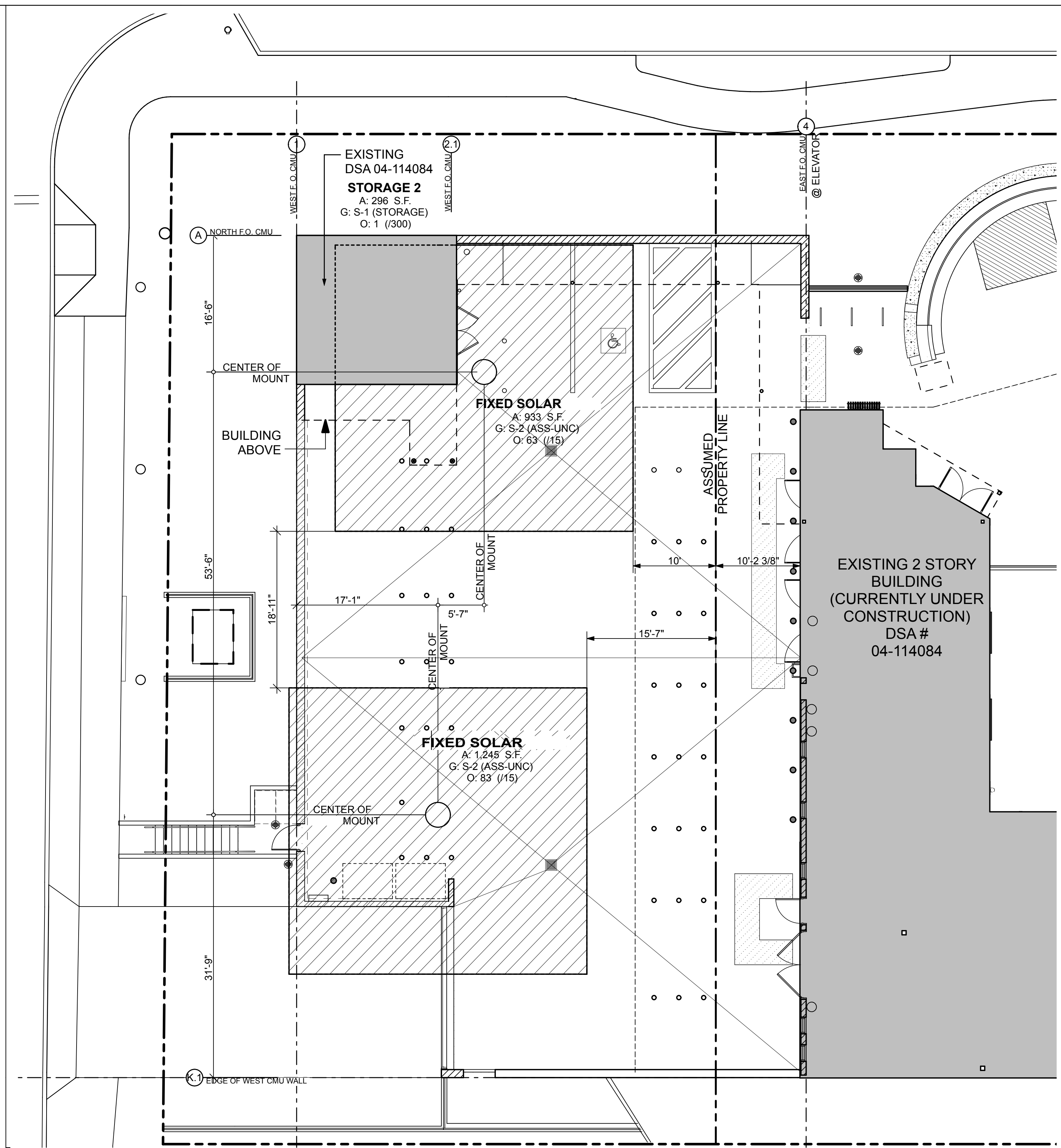

SOLAR - CODE ANALYSIS - MID LEVEL 1/8" = 1'-0"

**TYPE OF CONSTRUCTION**

TYPE V-B  
EXISTING MAIN BUILDING AND STAFF LOUNGE ARE SPRINKLERED IN ACCORDANCE WITH CBC 903.3.1.1 AND 508.3.1 (NON-SEPARATED OCCUPANCIES)

EXISTING STAFF LOUNGE AND NEW SOLAR SHALL BE CONSIDERED AS PORTIONS OF ONE BUILDING PER CBC 705.3, EXCEPTION.

EACH SPACE EXITS TO GRADE ON RESPECTIVE LEVEL

**OCCUPANCY:**  
STAFF LOUNGE AND SOLAR ARE NON-SEPARATED OCCUPANCY GROUP E, GROUP S-1 AND GROUP S-2 PER CBC 508.3  
GROUP S-1 IS THE MOST RESTRICTIVE PER TABLE 506.2 FOR AREA

**BUILDING HEIGHT, STORY AND AREA LIMITATIONS PER CBC TABLE 504.4 AND 506.2:**

HEIGHT: 40'  
STORIES: 1 STORY FOR BOTH GROUP E AND GROUP S1; 2 STORIES FOR GROUP S-2  
TABULAR BUILDING AREA FOR GROUP E: 9500 S.F.  
TABULAR BUILDING AREA FOR GROUP S1: 9000 S.F.  
TABULAR BUILDING AREA FOR GROUP S2: 13500 SF  
TABULAR AREA IS 9000 SF PER 508.3.2 (NON-SEPARATED OCCUPANCIES)

**SEPARATION PER CBC 508.3.3**

NO SEPARATION IS REQUIRED BETWEEN NON-SEPARATED OCCUPANCIES SQUARE FOOTAGE AND OCCUPANT LOAD DOES NOT EXCEED LIMITS FOR EACH USE PER CBC 903

**SEPARATION BETWEEN BUILDINGS ON SAME SITE PER TABLE 602**

FOR TYPE VB, IIB WITH SEPARATION DISTANCE TO ASSUMED PROPERTY LINE OF 10' OR MORE FIRE RESISTANT EXTERIOR WALLS ARE NOT REQUIRED.

**EXTERIOR OPENINGS BETWEEN BUILDINGS PER CBC 705.8.1 EXCEPTION 2**

BUILDING'S EXTERIOR WALLS AND EXTERIOR PRIMARY STRUCTURAL FRAME DO NOT REQUIRE FIRE RESISTANCE RATING PER TABLE 601 AND ARE PERMITTED TO HAVE UNLIMITED UNPROTECTED OPENINGS PER CBC 705.8.1, EXCEPTION 2

CODE ANALYSIS - SOLAR

EXECUTIVE DIRECTOR PFC	DATE
DIRECTOR PFC	DATE
DIRECTOR PROJECT MANAGEMENT PFC	DATE
DISTRICT ARCHITECT	DATE

R E V I S I O N S

NO.	DATE	DESCRIPTION

IDENTIFICATION STAMP  
DIV. OF THE STATE ARCHITECT  
OFFICE OF REGULATION SERVICES

AC \_\_\_\_\_ FLS \_\_\_\_\_ SS \_\_\_\_\_  
DATE \_\_\_\_\_

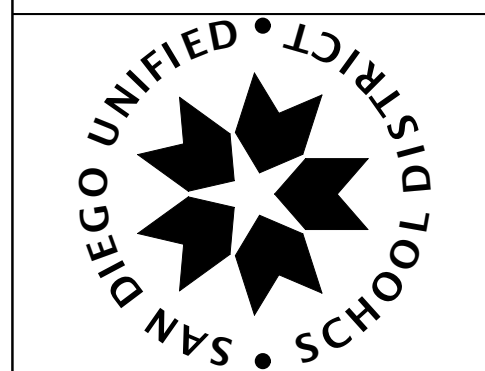
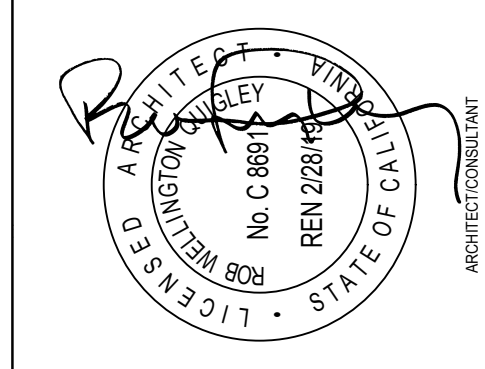

PREPARED FOR THE  
**BOARD OF EDUCATION**  
SAN DIEGO UNIFIED SCHOOL DISTRICT  
SAN DIEGO, CALIFORNIA

PREPARED BY THE  
FACILITIES PLANNING AND CONSTRUCTION  
PROJECT MANAGEMENT DEPARTMENT

SOLAR CODE ANALYSIS

**OCEAN DISCOVERY INSTITUTE**  
**48.30 KWDC PHOTOVOLTAIC PROJECT**  
4255 THORN STREET  
SAN DIEGO, CALIFORNIA

**CONSTRUCTION DOCUMENTS**

PROJECT NO.	R.S.	A.P.
FILE NAME	DATE	DRAWN
	3/22/17	CHECKED
REVISIONS	SHEET NO.	
	G-007	
	OF SHEETS	

SOLAR CODE ANALYSIS